

The Benefice of St Andrew's and St Peter's Clevedon



St Andrew's



St Peter's

**'We aim to continue working closely together
to reach out and serve our community really well'**

Our Location

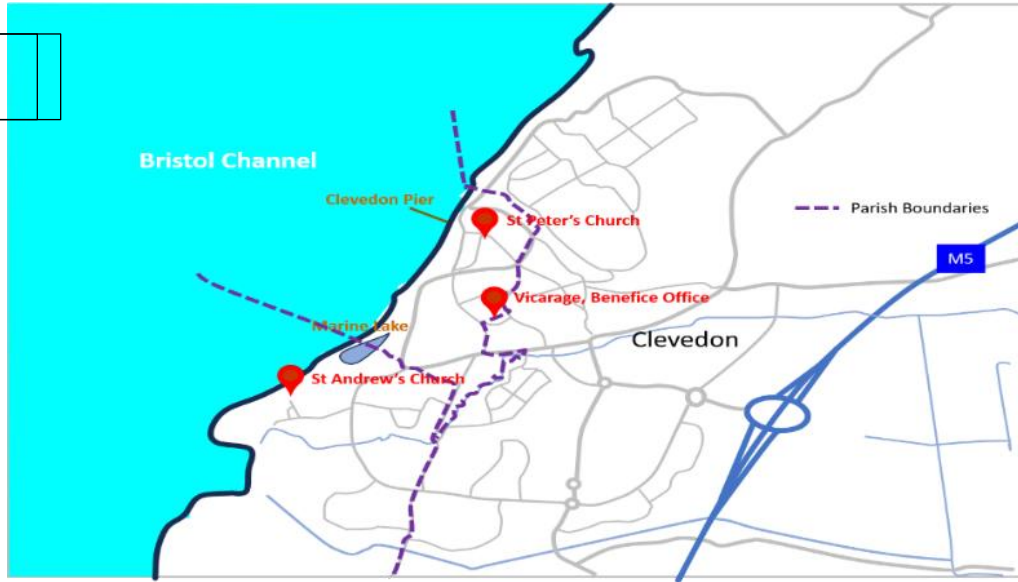

Clevedon, North Somerset



The Vicarage



The Benefice Office



**St Andrew's
Church,
Clevedon**



Clevedon Pier



**St Peter's
Church,
Clevedon**

'Serve the Lord with gladness' (Psalm 100 v 2)

Website: www.clevedonub.uk

The Benefice

Our Benefice consists of two churches in the lovely Victorian coastal town of Clevedon. For many years, we have operated independently and now, over the last nine months during our vacancy, we have been working well, in partnership together to bring about a sense of unity across the benefice.

At one end of the benefice sits St Andrew's, the historic and original Parish Church of Clevedon; situated overlooking the Severn Estuary and bordering Poet's Walk, a pretty walkway along the coastline which is extremely popular with visitors and locals alike. Sitting on the edge of a residential area and further beyond towards the M5, there are housing developments together with two of the five local primary schools in Clevedon (Mary Elton and St John's). The Church is open during daylight hours and welcomes visitors, any prayer requests left are followed up by the Prayer Ministry team.

St Andrew's has a modern Church Centre which is well used by both church and outside groups.

At the other end of the benefice is St Peter's, a modern church built in 1960, which is located close to the beautiful seafront by the pier and promenade. Situated in the commercial area of Hill Road and Alexandra Road, home to many independent shops, thriving restaurants, businesses, and Victorian houses. There are several retirement complexes and one care home in the parish. St Peter's has a well-equipped hall used by many community groups and church events. We are a small, mature congregation who strive to be a part of the community, and our church is kept open as much as possible as a peaceful haven in a busy area.

Both churches offer weekly services for the faithful, spirit-filled Christians who love the Lord, the Word and prayer, longing to serve God in the benefice and beyond to help all explore faith.

'and he is the head of the body, the church' (Col ch1 v18)

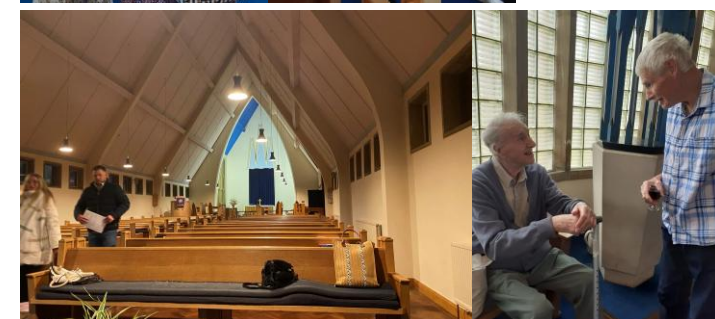

What We Offer

The Benefice

An enthusiastic team including: Four churchwardens, two PCCs, two treasurers who work well to ensure there are adequate finances to meet benefice financial commitments; we also have four licensed readers, two accredited worship leaders, two part-time parish administrators, two safeguarding officers, an organist, a music coordinator/advisor and dedicated hard-working teams of volunteers

Two beautiful churches, both quite different with congregations working well to grow closer together. A fabulous well-equipped Church Centre and a lovely Church Hall, both of which are well-used serving church and community groups alike.

- A spacious, modern 4-bedroom vicarage with a study and large garden
- A separate dedicated benefice office and meeting room adjacent to the vicarage
- A renewing relationship with two of the five local primary schools in Clevedon (Mary Elton and St John's Evangelist VA), paused during Covid. We are currently taking Open the Book into both schools.
- Good relationships with local residential care homes where some residents receive Holy Communion
- Links with other worshipping communities in Clevedon via Churches Together in Clevedon (CTiC). Outreach opportunities including Clevedon Chaplaincy
- A duty to promote a safe environment and culture in which the welfare of children, young people and adults is paramount and that everyone has a responsibility and role to play in protecting them.

We offer you a warm welcome, prayerful support and friendship, and a shared commitment to work well together.

We will support the on-going development of your ministry whilst providing personal time to rest, for recreation and holidays ensuring you have a healthy work/life balance.

The Vicarage



The Benefice Office

The Benefice Office is a modern building adjacent to the Vicarage, both of which were built in 2013 and are some distance away from both churches.

It is a well-equipped building which has a dedicated office for our two Parish Administrators, who work part-time. The office includes a meeting room with a photocopier, a table and chairs, and a small kitchenette area with a fridge. There is a toilet and a parking area.

The office is the central point of contact for all aspects of church life across the benefice which includes liaising with funeral directors, wedding and baptism enquiries, preparation of staff rotas, and responding to general enquiries and administration.

The office is open from 9:00am – 12noon, Monday to Thursday.



St Andrew's Church Centre



A Large Modern Church Centre with spacious hall, two meeting rooms and a fully functional kitchen.

St Andrew's Glebe and Church Garden



The Glebe



Church Garden



**Chickens Within
the Glebe**

St Peter's Church Hall

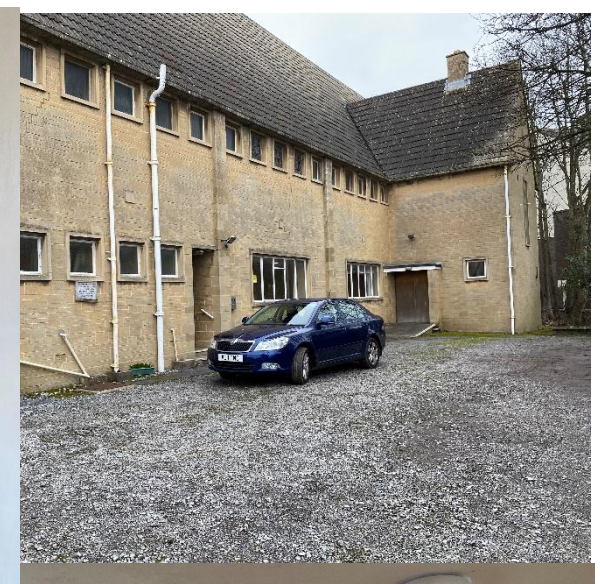

Life at St Andrew's

Mission Support

Home Groups

Weekly Benefice Prayer Group

Open Every Day

Community Christmas Day Lunch

Worship Team

Prayer Ministry Team

Prayer Stations

Special Services

Schools: Open the Book

Warm Welcome

Church Garden

Mothers Union

Cake & Craft

Harvest Supper

ONE (At a Local Pub)

One Hour

One Drink

One Question about Faith

The Glebe

Toddlers

Foodbank

Book Group

Quiz Evenings

Poetry Reading

Art 4 All

Team of Dedicated Bell Ringers

Solo's Group

Cuppa and Company

Big Community Breakfast

Film Nights



Life at St Andrew's



'Therefore, go and make disciples of all nations, baptising them in the name of the Father and of the Son and of the Holy Spirit' (Matthew ch28 v19)

Life at St Peter's

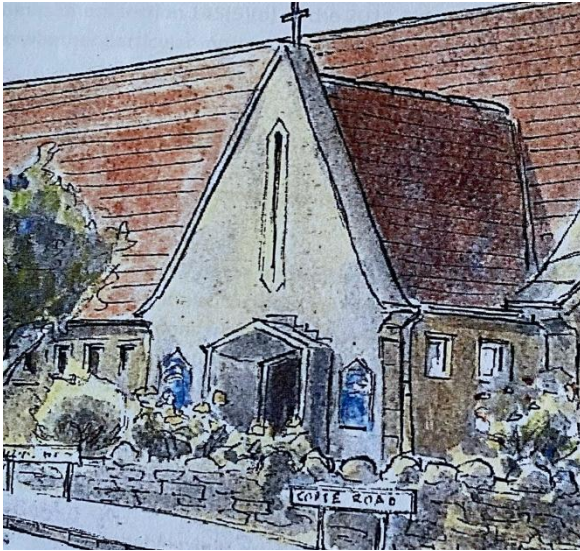

OUTREACH TO BUSINESSES. CAROLS AND HARVEST SERVICES

A WARM WELCOME. YOGA, ART, DRAMA GROUPS IN OUR HALL

MOTHERS UNION. Support the Foodbank

WELCOME TO ST PETER'S

HOME COMMUNION & PASTORAL CARE

CHURCHES TOGETHER

OUR LOCATION BY THE BEACH AND PIER

ORGAN MUSIC.

FEELING GOD'S PRESENCE IN THE PEACE AND QUIET

FELLOWSHIP AFTER OUR SERVICES.

LINKS WITH CARE HOMES

SUNDAY MARKET OUTREACH. SERVICES THAT ARE THOUGHT PROVOKING.

MONTHLY TEA AND CHAT OPEN TO ALL

SAFEGUARDING.

CLEVEDON CHAPLAINCY

LOVINGLY WELL-MAINTAINED CHURCH, HALL, AND GARDEN

HELP TO GET TO CHURCH.

EXPERIENCING GOD'S LOVE

HOPE FOR THE FUTURE

THIS IS WHO WE ARE

CHRISTIAN FRIENDSHIP AND A SENSE OF BELONGING



Life at St Peter's



"...you are Peter, and on this rock, I will build my church" (Matthew Ch 16 v18)

Challenges

As a result of consultations with our congregations, we recognise that there will always be challenges, shared and specific to, our separate parishes. Navigating the vacancy is already helping us share and support each other and drawing the two parishes closer.

- To work closely together, across the Benefice, sharing our many gifts and talents
- We are challenged to take the mission of our churches outside the walls of our buildings. We want to develop pathways into and with the various communities where we live and work.
- We all recognise that attracting young people to our congregations is not easy, but the future of the Church depends on growth.
- The challenge of ageing congregations is evident in limitations such as transport and health issues. We realise that accepting change, relating to worship styles and pastoral care can be difficult, but we must identify and meet the needs of all ages and abilities.

We believe that we have the kindness and willingness to adapt, and with the guidance of a new vicar and God's help, we can achieve our aims.

'Cast all your anxieties on him, for he cares about you' (1 Peter 5:7)

Our Aspirations

We strive to make the best use of our resources, both people and buildings, to demonstrate God's love for everyone.

- To value and nurture our current congregations, to meet pastoral and spiritual needs and to grow in faith.
- To grow our worshipping communities and be relevant and visible in our busy world, to be trained and equipped to improve our outreach to people of all ages. We would like to extend our relationship with our existing Toddler Group families and our work with schools (Open the Book); also introduce social groups to encourage and welcome all, spreading Christ's love within the community.
- To become more involved with Clevedon Town Chaplaincy, an ecumenical team of Christians set up and trained by Churches Together in Clevedon, supporting those who work in our local businesses, shops, and cafes.
- To improve and grow our pastoral care teams, identifying what training, resources and development may be needed, enabling them to be more effective, thus ensuring our church families feel supported and valued.

'Ask and it will be given to you; seek and you will find; knock and the door will be opened to you.' (Matthew ch7 v7)

Is This You?

We are eager to recruit a Vicar for St Andrew's and St Peter's, both located in the beautiful surroundings of Clevedon in North Somerset. We are two churches and one benefice seeking to reach out to help the community and inspire others to come to Christian faith.

We are praying for our new Vicar to:

- Be a confident leader able and willing to delegate.
- A good listener and a 'people person' with the ability to inspire, motivate and encourage the church families of both churches.
- Be a person of vision, spiritually led by the Gospel and a good teacher.
- Be a Disciple-maker, helping people connect with God and grow into faithful followers of Jesus.
- Be pastorally caring with a heart for all age groups.
- Be actively involved in the whole local community, including the schools and CTiC (Churches Together in Clevedon)
- Be fully inclusive and a good communicator of unity across all spheres.

We offer:

- Supportive teams of Churchwardens, Licensed Readers, Accredited Worship leaders and dedicated helpers
- A modern 4-bedroom Vicarage home, study, and a large garden
- An independent Benefice Office with two part time Parish Administrators
- Two beautiful church buildings plus a Church Centre and a Church Hall
- Congregations wanting to grow and welcome others.

We hope that in reading our Parish Profile you will feel encouraged to apply for this post and we look forward to working with you. You are assured of a loving welcome here in Clevedon.

Facts and Figures

Church (2024 figures)	St Andrew's	St Peter's
Total Income	£129,006	£25,242
Total Expenditure	£137,166	£25,252
Parish Share	£66,241	£15,016
Parish Share (% Paid)	100%	100%
Restricted Reserves	£205,670	-
Unrestricted Reserves	£81,532	£21,606
Electoral Roll	120	21

Statistics for Mission from 2024	St Andrew's	St. Peter's
Regular Worshippers	62	16
Baptisms	3	0
Marriages in Church	3	0
Funerals Conducted	6	2
Funerals Conducted Elsewhere	7	0
Interment of Ashes	22	2

St Peter's Sunday Services	
1 st Sunday	11am Morning Prayer
2 nd Sunday	11am Morning Prayer (BCP)
3 rd Sunday	11am Morning Prayer
4 th Sunday	11am Holy Communion
5 th Sunday	11am Morning Prayer

Services are traditional
worship style

St Andrew's Sunday Services	
1 st Sunday	10am Family Worship
2 nd Sunday	10am Family Holy Communion
3 rd Sunday	10am Family Worship
4 th Sunday	10am Family Worship
5 th Sunday	10am Family Worship

Services are varied and are supported by a
Worship Group playing both hymns and modern
worship songs

Church Fabric

Quinquennial Reports

- **St Andrew's QI 2024 Summary**

General Condition of the Fabric: The building is very well cared for, and the fabric is in good order as a result of a pro-active fabric maintenance team. Ongoing maintenance is coordinated and planned into the annual calendar of activities.

We are currently investigating the provision of a new IR heating installation, toilet facilities, kitchen servery, and externally, handrailing.

- **St Peter's QI 2023 Summary**

“St Peter's is in good condition and the Churchwardens and PCC should be congratulated for the way the building is maintained.”

Routine maintenance and attention paid to keeping the downpipes and guttering clear. Some windows to be redecorated in the future.

Deanery Statement

The Benefice of St Andrew's and St Peter's, Clevedon, is in the Deanery of Portishead. We are a friendly deanery people get on well together and the clergy chapter is a place of mutual support and encouragement which is good at working out ways to help one another.

We are committed to working together and ask all new clergy in the deanery to consider themselves a resource to the wider deanery. Most parish clergy have interests and specialisms. We encourage co-operation and working across parish boundaries.

We have an energetic Deanery Mission and Pastoral Group and an experienced Deanery Leadership Team which is engaged in moving forward across the whole deanery.

The twenty-three parishes (plus a conventional district) of the Deanery of Portishead have set ourselves a challenging deanery plan to:

- **inspire** us to respond to God's call where we are.
- **equip** people to share in ministry and leadership.
- **communicate** – to better share and publicise events or initiatives that are taking place in our own local context.

We are praying that these next few years will be a fruitful and rewarding time to be in the Portishead Deanery and we look forward to meeting and working with the newly appointed Incumbent of the Benefice. If you would like to find out more, or would value an informal chat about applying, please do call any of us on the numbers below.

Rob Eastwood Dewing Co Area Dean – 01275 846592

Astrid Tiesema-Samsom Co-Area Dean – 07791 028060

Rob Norman Lay Dean – 07973 753837

Diocesan statement – our vision for growth and transformation



Introduction

We are delighted that you are considering whether this post of Vicar of the Benefice of Clevedon, St Andrew and St Peter in the Diocese of Bath and Wells might be right for you. In order to help your prayerful discernment, we want to share a bit about our diocesan vision, within which we hope your own ministry might flourish.

Appointing a priest incumbent is amongst the most significant decisions that any benefice makes. When appointments work out well, they contribute significantly to parishes flourishing and growing in a host of different ways – in spiritual depth, in impact within local communities and in the numbers of people becoming part of the local church. Such flourishing is not, of course, all down to the person appointed as priest. It depends first and foremost upon God. It also depends upon everyone in a benefice being willing and able to contribute their unique gifts, skills, resources, and abilities: working alongside their priest and sharing in the ministry of the benefice.

The flourishing and growth of churches always needs attention. It is especially important for us today, as we seek to recover from the effects of the Covid pandemic which accelerated the pattern of decline in church attendance that we have seen across our diocese.

Thankfully, there are signs that we are recovering from the impact of the pandemic. Not only does national church data show that our average adult weekly church attendance rose between 2021 and 2022 but, even more encouragingly, we have seen many churches around our diocese develop approaches that respond to the opportunities and challenges in their local context and enable growth to happen.

A vision for growth and transformation

In light of the challenges and opportunities we face, we feel our aim across all our parishes needs to be growing our churches, within and beyond our church buildings, in both numbers and depth of faith, so that we can better work for the transforming of our communities and the life of God's Kingdom amongst us.

Our shared priorities

To help us pursue this aim, and following consultation across the diocese in 2023, we are inviting all parishes to focus on four particular areas of our ministry together. It is important for clergy considering working in our diocese to know what these priorities are, even though what they look like in practice will vary in each place.

To value and cherish the people and resources we already have

We aim to ensure each person is well supported and equipped as a follower of Jesus Christ and for any ministries they may feel called to undertake, within the local church and wider community. We are committed to supporting the well-being of all our leaders and church officers, both lay and ordained. We have a fully funded clergy well-being service, the offer of peer support groups, and an excellent team of diocesan support staff fully focused on supporting our parishes, chaplaincies, and schools.

To develop new Christian worshipping communities

Whether it be new forms of worship in a wide variety of settings and times, church revitalisations or church plants, we long to see the good news of Jesus connect with the people in our communities that our traditional offerings struggle to reach.

To share in ministry and leadership

We are committed to the New Testament vision of the church as a vibrant body of people all using their God-given gifts. We are committed to a model of shared local ministry: raising up and equipping lay and ordained leaders able to share together in leading the church and serving God's world.

To deepen and grow faith.

This is foundational to all we do. We long to see people of all ages and backgrounds, but especially children, young people, and young adults, having more opportunities to discover, explore and grow in faith.

The outcome we are looking for.

When he talks about his own ministry in 1 Corinthians, Paul captures the dynamic we are seeking to achieve. “I planted,” he says, “Apollos watered, but God gave the growth” (1 Cor 3: 6). We know that our churches will only flourish and grow as a result of God’s action among us – it is God who gives the growth.

But Paul is also clear that we have a part to play too – in watering and planting, in doing the things that enable the conditions for God’s growth to be supported. So, covered by prayer, our confident hope is that if we are intentional in seeking God’s guidance in planning and supporting growth, then God will honour that to see his people flourish and thrive - in spiritual depth, in impact within local communities, in the numbers of people becoming part of the local church and in transforming communities locally and beyond.

Local shaping and diocesan support

There cannot be any ‘one size fits’ all approach to turning the priorities outlined above into action. They always need to be adapted to local circumstances, opportunities, and needs. The task of our diocesan support services is to get behind all that local benefices are doing and apart from their general support, there is specific support for exploring how to grow new Christian communities, how to discern and equip a growing range of ministries in your context and how to work well with children and young people. All these areas of support are grounded in exploring what it means to live out our faith.

What implications does this have for the appointment of clergy?

It is important for us all to appoint clergy to benefices who are ready, willing, and able to pray for and share in the vision we have for the flourishing and growth of churches and Christian life in our diocese. We want to create an environment that could be described as high challenge, high support. This means appointing clergy who will not only value all that already exists but will be eager to work with others to build on and develop it. It means appointing clergy who are committed to learning, being creative, and to starting with the gifts God has given to them, their benefice, and the wider community. We are therefore looking to appoint candidates who will be committed to

praying and intentionally seeking the growth and flourishing of the benefices in their care relish and expect to work in an environment that is high challenge, high support, work joyfully and collaboratively with those who share with them locally in ministry and leadership, with their congregations and with others in their locality, to identify ways to grow and develop their churches with the grain of local priorities, resources, skills and passions enjoy working in partnership with deanery and diocesan colleagues.

We hope this might be you! We hope that you would like to join us on the adventure and course we have set for our next ten years.

We are praying that God will send us the right labourers for the harvest that God has set before us. Could this be you?

A handwritten signature in black ink that reads "Michael." with a small cross symbol to the left of the first letter.

Bishop Michael

A handwritten signature in black ink that reads "Charlie" in a cursive style.

Archdeacon of Bath